

First Floor

| Room Name | Sq. Ft. | Dimensions (Ft.) | Ceiling Ht. (Ft.) | Classroom | Theater | Banquet 10 | Reception | Conf. | U-Shape | H-Square |
|--------------------------|---------|------------------|-------------------|-----------|---------|------------|-----------|-------|---------|----------|
| Bennett Boardroom | 465 | 15.00' x 31.00' | 9 | - | - | - | - | 20 | - | - |
| Cross Timbers Ballroom | 3,432 | 78.00' x 44.00' | 13 | 160 | 350 | 180 | 315 | - | - | - |
| Cross Timbers I | 1,144 | 26.00' x 44.00' | 13 | 55 | 105 | 70 | 105 | 26 | 38 | 42 |
| Cross Timbers II | 1,144 | 26.00' x 44.00' | 13 | 55 | 105 | 70 | 105 | 26 | 38 | 42 |
| Cross Timbers III | 1,144 | 26.00' x 44.00' | 13 | 55 | 105 | 70 | 105 | 26 | 38 | 42 |
| Denton Creek | 414 | 23.00' x 18.00' | 10 | 18 | 20 | 24 | 11 | 14 | 15 | 18 |
| Grape Vine Springs Patio | 1,960 | 28.00' x 70.00' | - | - | - | - | 125 | - | - | - |
| Heritage Ballroom | 12,640 | 158.00' x 80.00' | 16 | 700 | 1,300 | 800 | 1,300 | - | - | - |
| Heritage I | 1,080 | 40.00' x 27.00' | 16 | 50 | 110 | 70 | 96 | 45 | 30 | 35 |
| Heritage II | 1,040 | 40.00' x 26.00' | 16 | 50 | 130 | 80 | 96 | 45 | 30 | 35 |
| Heritage III | 1,080 | 40.00' x 27.00' | 16 | 50 | 110 | 70 | 96 | 45 | 30 | 35 |
| Heritage IV | 3,120 | 39.00' x 80.00' | 16 | 150 | 310 | 180 | 250 | - | 75 | 90 |
| Heritage V | 3,120 | 39.00' x 80.00' | 16 | 150 | 310 | 180 | 250 | - | 75 | 90 |
| Heritage VI | 1,080 | 40.00' x 27.00' | 16 | 50 | 110 | 70 | 96 | 45 | 30 | 35 |
| Heritage VII | 1,040 | 40.00' x 26.00' | 16 | 50 | 130 | 80 | 96 | 45 | 30 | 35 |
| Heritage VIII | 1,080 | 40.00' x 27.00' | 16 | 50 | 110 | 70 | 96 | 45 | 30 | 35 |
| Jenkins Boardroom | 465 | 15.00' x 31.00' | 9 | - | - | - | - | 20 | - | - |
| Nash Boardroom | 300 | 12.00' x 25.00' | 10 | - | - | - | - | 12 | - | - |
| Tate | 720 | 15.00' x 48.00' | 9 | 18 | - | 36 | 36 | 25 | 20 | 24 |
| West Boardroom | 225 | 12.00' x 18.00' | 10 | - | - | - | - | 8 | - | - |

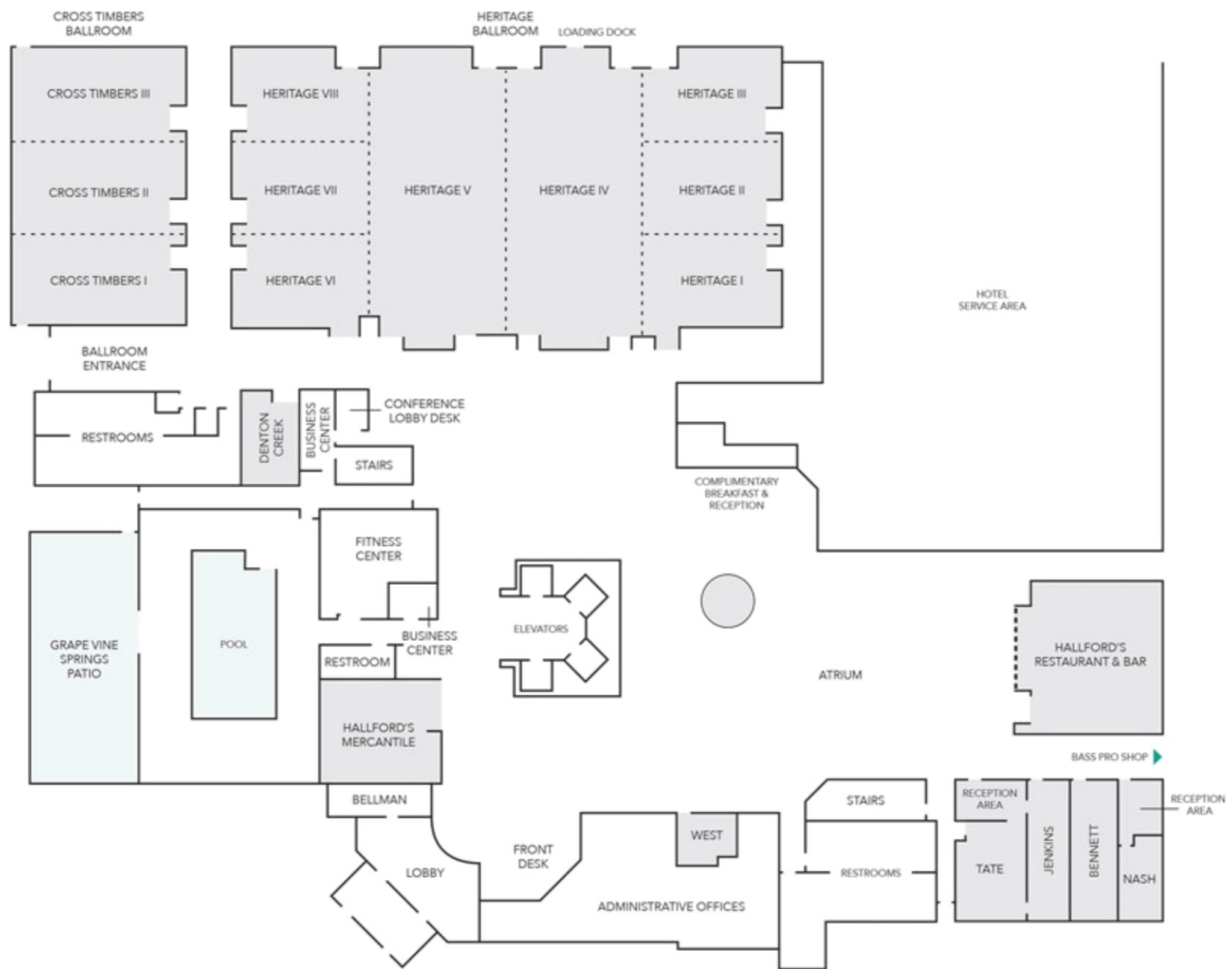

Second Floor

| Room Name | Sq. Ft. | Dimensions (Ft.) | Ceiling Ht. (Ft.) | Classroom | Theater | Banquet 10 | Reception | Conf. | U-Shape | H-Square |
|---------------|---------|------------------|-------------------|-----------|---------|------------|-----------|-------|---------|----------|
| Dooley | 1,161 | 43.00' x 27.00' | 8 | 60 | 130 | 70 | 112 | 30 | 35 | 40 |
| Franklin | 806 | 26.00' x 31.00' | 8 | 20 | 50 | 50 | 50 | 12 | 20 | 30 |
| Lonesome Dove | 312 | 24.00' x 13.00' | 8 | - | - | - | - | 10 | - | - |